

MICROFILMED

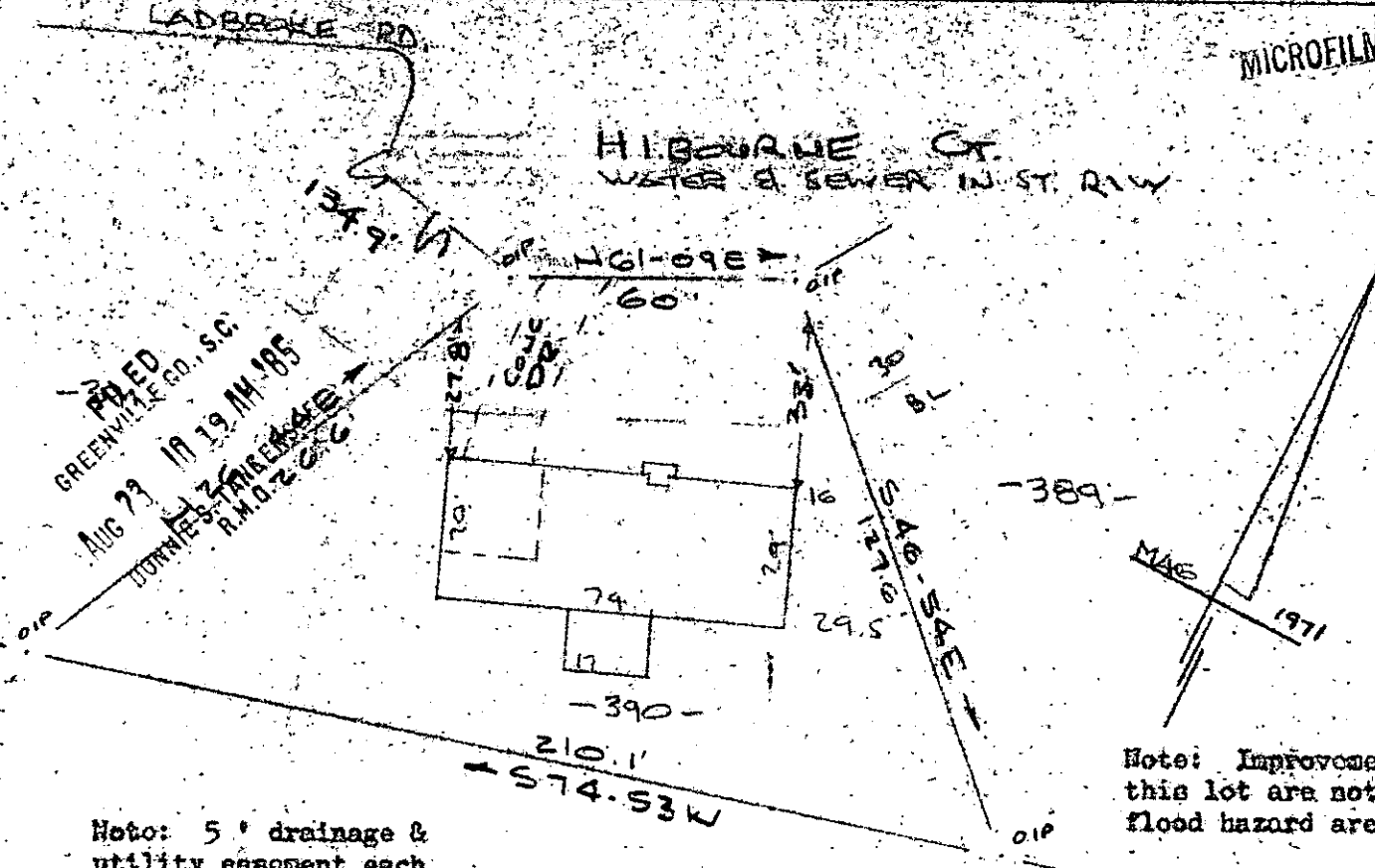

Note: 5' drainage & utility easement each side of side and rear lot lines.

Note: Improvements on this lot are not in a flood hazard area.

PROPERTY OF  
**HOWARD P. KELLER & GAYLE M. KELLER**  
 NEAR GREENVILLE, S. C.  
 SCALE 1" = 40' 14 AUG 1985

This is to certify that on the 14th day of August, 1985, I surveyed the property shown on this plat, being known as lot 390 on plat of DEL NORTE SECTION III and recorded in the RMC Office Greenville County, S.C., in Plat Book "4N" at Pages 14 & 15; and that the property lines, walls and buildings are as shown hereon, and that the walls and buildings located on said lot do not encroach or project on adjacent street or property, and that no adjacent walls or buildings encroach or project on said premises, and no power lines cross this property except as shown hereon.

Also known as PROPERTY OF HOWARD P. KELLER & GAYLE M. KELLER and recorded in Plat Book at Page

*R. B. Bruce*  
 H. B. Bruce, RLS #1952

AUG 23 1985

11-W-5 6112

CAROLINA SURVEYING CO.  
 112 Manly St.  
 Greenville, S. C.

AUG 23 1985

Recordable Plat